



# LYCO® EXCESS FLOW VALVES

Because Safety is Your Number One Priority

When it comes to the distribution of natural gas, safety is always the number one priority. And part of any comprehensive gas distribution safety regimen is the inclusion of high quality, dependable LYCO® Excess Flow Valves (EFVs). LYCO® EFVs are the first responders in the event of a damaged gas line. Patent-protected LYCO® EFV technology shuts down the line's flow and keeps it closed until the line is repaired and gas pressure returns to normal.

## Available in Three Different Designs:

- EFV I – ½" CTS to 1 ¼" IPS
- EFV II – ½" CTS
- CEFV – 1 ¼" IPS and 2" IPS

## Calculate the Size You Need

Lyall's customizable EFVs are suitable for nearly any configuration. Visit our website at [rwlyall.com/products/lyco\\_excxs\\_flow\\_valves](http://rwlyall.com/products/lyco_excxs_flow_valves) and download the Lyall EFV Calculator to help you determine the EFV size and design necessary for your specific application.

## Design Features:

- Meets or exceeds requirements of part 49 CFR 192.381.
- The spring is protected from the high velocity gas stream.
- Resistant to clogging caused by line dust and particulate buildup.
- EFV II provides superior ½" CTS service protection with a patented design that provides the lowest pressure drop in the industry.
- A bypass feature allows an auto-reset after service line repair.
- The modular design allows integration into a multitude of pipes and fittings.

## Additional Lyall Products

Transition Fittings / Anodeless Risers / Transition Risers / Polyethylene (PE) Valves / Commercial Meter Sets / Industrial Meter Sets and Spools

### LYCO® EFV I

Designed primarily for ¾" IPS and 1" IPS applications.



**Open Position**



**Closed Position**

### Configuration Options:

- Medium or high density PE pipe
- Extended lengths of PE pipe
- Steel pipe
- Reducers or socket fusion couplings
- LYCOFIT® Mechanical Couplings
- LYCOFIT® Mechanical and saddle fusion service tees

We can customize configurations as required.

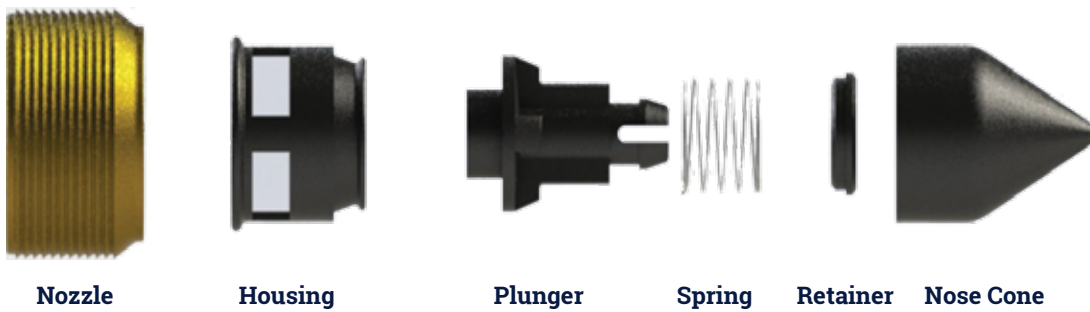

### LYCO® EFV II

Designed primarily for ½" CTS applications.



**Open Position**



**Closed Position**

### Configuration Options:

- Medium or high density PE pipe
- Extended lengths of PE pipe
- Socket fusion couplings
- Saddle fusion service tees

We can customize configurations as required.



### LYCO® CEFV

Designed primarily for 1 ¼" IPS and 2" IPS applications.



**Open Position**



**Closed Position**

### Configuration Options:

- Medium or high density PE pipe
- Extended lengths of PE pipe
- Reducers or socket fusion couplings

We can customize configurations as required.

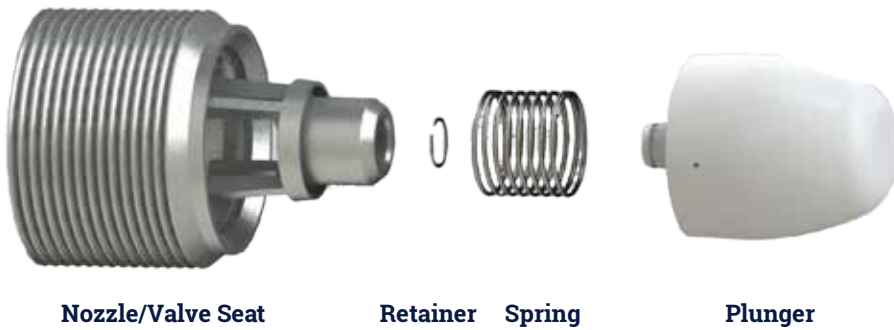

**Nozzle/Valve Seat**

**Retainer Spring**

**Plunger**

### LYCO® Excess Flow Valves



**EFV I**

**EFV II**

**CEFV**

**S = Stick**

**A = Assembly**

Product	Series	SERVICE LINE SIZE - POLYETHYLENE									STEEL	
		1/2" CTS .090	1/2" IPS DR 9.3	3/4" CTS .090	3/4" IPS DR 11	1" CTS .090	1" CTS .099 - .102	1" IPS DR 11	1 1/4" IPS DR 10-11	2" IPS DR 11	NPS 3/4" - 40	NPS 1" - 40
EFV I	350	A	A	A	S/A	S/A	S/A	S/A	S/A		S	S
EFV II	375	S/A	A									
EFV II	400	S/A	A									
EFV II	450	S/A	A									
EFV I	475	A	A	A	S/A	S/A	S/A	A	S/A		S	S
EFV II	775	S/A	A									
EFV I	775	A	A	A	S/A	S/A	S/A	A	S/A		S	S
EFV I	1200		A	A	S/A	S/A	S/A	A	S/A		S	S
EFV I	1800		A	A	S/A	S/A	S/A	A	S/A		S	S
CEFV	1800		A	A	A	A	A	A	A	S/A		
CEFV	2600		A	A	A	A	A	A	A	S/A		
CEFV	3900		A	A	A	A	A	A	A	S/A		
CEFV	5500		A	A	A	A	A	A	A	S/A		

### Sticks



EFV I



EFV I – Steel



EFV II



CEFV

### Contact Info

#### California Office

2665 Research Dr.  
Corona, CA 92882

#### Wisconsin Office

16875 West Ryerson Rd.  
New Berlin, WI 53151

#### Customer Service

(800) 535-9255  
Sales@RWLyall.com

LIT-EFVDS-3B

RWLyall.com

### Assemblies



Socket Fusion Couplings



Reducers



LYCOFIT® Mechanical Couplings



Saddle Fusion Service Tees



LYCOFIT® Mechanical Service Tees

### Specifications

LYCO EFVs meet or exceed the requirements of ASTM F2138, MSSS-115 and MSS-142. For a complete Technical Data Package of design specifications and test data, please contact your Lyall sales or customer service representative.